

# Dynamic Cube (DC) Series Brochure

Powered by 16 years of manufacturing experience and robust supply chain resources, EZ LED Visual is dedicated to providing solid and stable LED video display products that enable our clients' designs to shine and amaze their audience. Whether it's information visualization, immersive experiences, mission-critical applications, or interactive display solutions, EZ LED Visual is ready to help you make it happen.

## Product Features

- Pixel pitches: 3.9mm, 4.8mm, 6.25mm, 7.8mm, 10.4mm
- **Dynamic Pro Technology** supported by high brightness, high refresh, and high grayscale
- All-weather IP65 rated
- Light weight design
- Slim panel design (**ADA Compliant**)
- Energy-efficient design (30% lower than industry average)
- Quick locking system to enable fast install
- Wall mounting, floor standing, and hanging compatible
- Wall-mount-free install (LED wall size 60'x35' or below)
- Front serviceable and front installable
- Curvable for concave applications (panel-based faceted curve)
- Custom 90-degree corner solution available (optional)
- Naked eye 3D compatible



# Product Overview

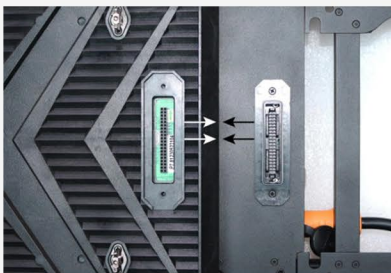
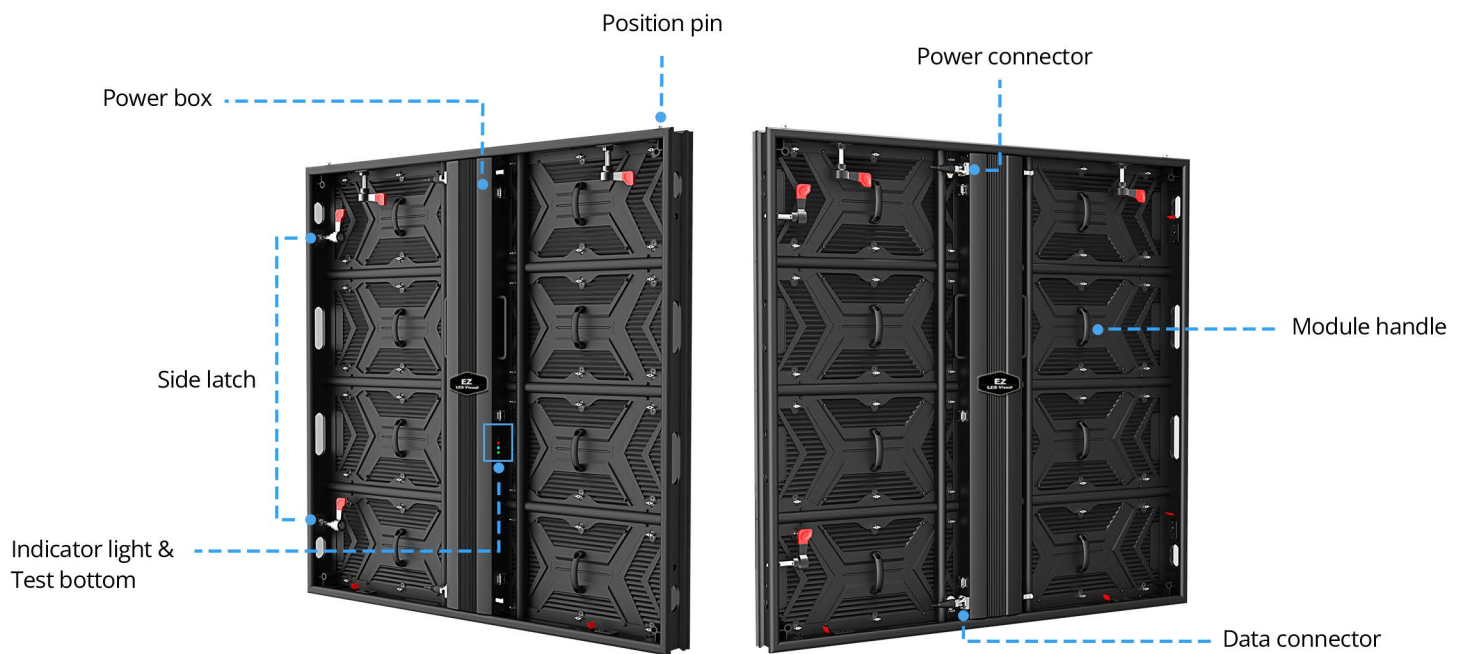

High-precision CNC side latch

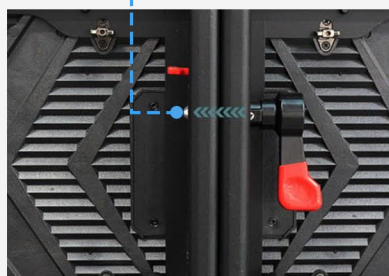

Front maintenance

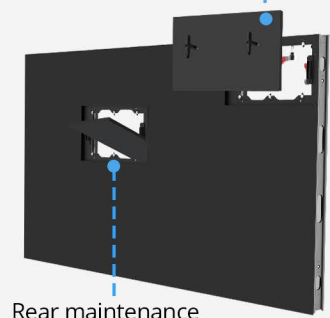

## Hot-swappable

Hard connection supports hot-swapping without interrupting the rest of the LED wall

## Fast installation

Side latches featuring quick locking mechanism ensures fast install.

## Front and Rear maintenance

# Dynamic Pro Technology

- High brightness



High brightness



Low brightness

- High refresh



High refresh



Low refresh

- High grayscale



High grayscale



Low grayscale



## H/V 160° Wide View Angle



Weight is 35% lighter



IP65 for both front and back side



Energy saving up to  
**30%**



Dynamic Cube Series	1 sqm(w/m <sup>2</sup> )
Average power consumption	100-200W
Max power consumption	650W

Industry average	1 sqm(w/m <sup>2</sup> )
Average power consumption	425W
Max power consumption	1000W



# Applications

- ① Digital Signage (DOOH)
- ② Commercial property
- ③ Naked eye 3D
- ④ Corporate
- ⑤ Entertainment
- ⑥ Hospitality
- ⑦ Education

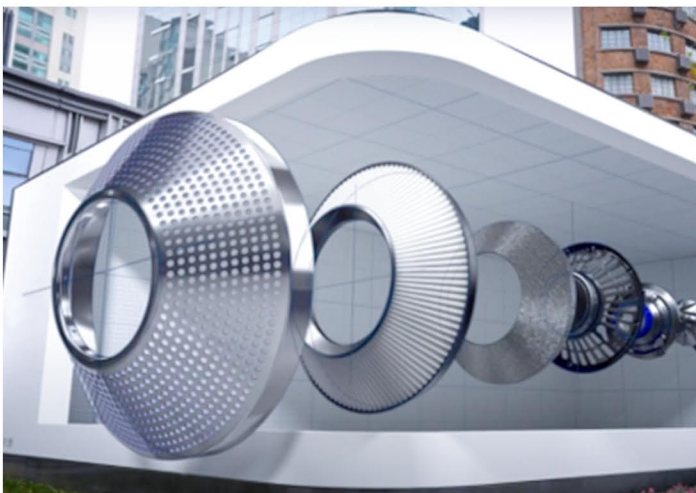

# Technical Specifications

## EZ LED Dynamic Cube (DC) Series

Product Model	DC 2.9mm	DC 3.9mm	DC 4.8mm	DC 6.25mm	DC 7.8mm	DC 10.4mm
Per Panel Resolution	336*336	256*256	208*208	160*160	128*128	96*96
LED Type	3-in-1 SMD					
Panel Size (W*H*D)	1000x1000x83 mm / 39.37"x39.37"x3.27"					
Brightness	6000 nits (adjustable)					
Refresh Rate	2880-3840 HZ					
Grayscale	14-16 bit					
Contrast Ratio	5000 : 1					
View Angle	160° Horizontal / 160° Vertical					
Installation Access	Front Install / Rear Install					
Service Access	Front Service / Rear Service					
Panel Material	Aluminum					
Per Panel Weight	22.5KG / 49.5 LBS					
Per Panel Power Consumption (max)	650W					
Per Panel Power Consumption (typical)	200W					
Brightness Uniformity	>97.5%					
Color Uniformity	>97.5%					
Color Gamut	100% NTSC					
Color Temperature	3,000-10,000 K					
Service Life	100,000 Hours					
Working Voltage	100V-240V Auto-switching					
Operating Temperature (10-85% relative humidity, non-condensing)	-20° to 50° C / -4° to 122° F					
Alternative Panel Size (W*H*D)	1000x500 mm / 39.37"x19.69"   1500x1000 mm / 59.06"x39.37"   1500x500 mm / 59.06"x19.69"					

All rights reserved by EZ LED Visual Co.,Ltd.